



EPISCOPAL DAY SCHOOL OF CHRIST CHURCH PARISH
 Early Learning Center
 St. Michael's Campus

Childcare at the St. Michael's Campus will be geared toward serving the needs of the working family and will be open year round from 7:00 a.m.-5:30 p.m. There are three programs available for families to consider, with priority given to those entering the full-year program.

The **School Day Program** is offered for our families whose children attend school during the year, but do not need care during the summer months or during school vacations. The hours are 8:00 a.m. – 2:30 p.m. daily when the EDS main campus is in session. EDS Main Campus calendar is available at www.edsc.org. Children with siblings at Episcopal Day School have priority admission to this program and spots are limited.

The **Extended Day Program** is offered only during the school year, but includes childcare on days when the regular school is not in session with the exception of designated school holidays. Hours are from 7:00 a.m. – 5:30 p.m. daily. Care is not offered during the summer months in this program. Children with siblings at Episcopal Day School have priority admission to this program and spots are limited.

The **Full-Year Program** is a full-time, year-round child care program offered for working families. The hours are 7:00 a.m. – 5:30 p.m. and the program operates throughout the year with the exception of designated school holidays.

Registration Fees

Registration fees are as follows and are due at the time of enrollment. The registration fee and signed enrollment agreement secures your child's place in our classes, which are limited to a designated number of students.

- first child: \$300
- second child: \$150
- additional children: \$100

Tuition

Tuition for the 2010-11 school year is listed below and includes all classroom materials. Tuition does not include personal items such as diapers, wipes or meals. There is a 6% tuition discount for the second child in a family and an 11% discount for the third and fourth children from the same family. Tuition is billed monthly and payable by the 15th of each month.

<u>Age</u>	<u>School Day</u> <i>8:00 a.m. -2:30 p.m. Aug - May</i>	<u>Extended Day</u> <i>7:00 a.m. – 5:30 p.m. Aug – May</i>	<u>Full-Year</u> <i>7:00 a.m. – 5:30 p.m. Year-round</i>
Infant	\$624 / month	\$865 / month	\$800 / month
1 yr old	\$598 / month	\$820 / month	\$760 / month
2 yr old	\$572 / month	\$775 / month	\$715 / month
PreK(3&4)	\$484 / month	\$706 / month	\$688 / month
PreK (3&4) Half Day		8:00 a.m. – 12:00 noon	\$438 / month

Drop-In Care:

- Early Care (7:00 – 8:00 a.m.) \$1.00 / day
- Extended Care (2:30 – 5:30 p.m.) \$6.00 / hour

Designated School Holidays

The entire school (both campuses) will be **closed** on the following days and Episcopal Day Camp programs will not be offered.

Monday, September 6	Labor Day
Thursday, November 11	Veteran's Day
Thursday & Friday, November 25-26	Thanksgiving Holiday
Friday, December 24	Christmas Eve Holiday
Friday, December 31	New Year's Eve Holiday
Monday, January 17	Martin Luther King Day
Monday, February 21	President's Day
Monday, May 30	Memorial Day
Monday, July 4	Independence Day
Monday-Friday, August 1-12	Teacher Break and Work Week

Opening Dates for Infants, Ones and Twos

Friday, August 13 th	Open House 9:00 -11:00 a.m.
Monday, August 16 th	First Day of School

Opening Dates for PreK3 & PreK4

Tuesday, August 17 th	Open House 9:00-11:00 a.m.
Wednesday, August 18 th	First Day of School

Episcopal Day Camp (EDC)

EDS provides child care on school vacation days through our EDC program. Children who are enrolled in the Extended Day and Full-Year program are automatically enrolled in the camp at no additional charge. Children who are enrolled in the School Day program are eligible to enroll in the camp on a first-come, first-serve basis. The cost for the camps is roughly \$35.00 per day. Camps will be available on the following school holidays:

Thursday and Friday, October 14-15	First Quarter Break Camp
Monday-Wednesday, November 22-24	Thanksgiving Camp
Monday-Thursday, December 20-23	Christmas Camp
Monday-Thursday, December 27-30	New Year's Camp
Thursday and Friday, March 10-11	Third Quarter Break Camp
Monday-Friday, April 25-29	Spring Break Camp

Summer: Camps available for eight weeks during the summer except August 1st -12th for teacher break and work week.

Snacks & Meals

Snacks will be provided daily in the morning and afternoon. Dietary needs will be taken into consideration. Lunches will be offered under a separate meal plan for an additional charge.

Campus

The property at 601 N. Palafox Street consists of a full city block in the historic North Hill District close to the intersection of Palafox and Cervantes, just two blocks north of the main campus at 223 N. Palafox Street. It has nine classrooms; a large grassy area and huge playground; a spacious auditorium/cafeteria with a fully-equipped commercial kitchen; a library; and several administrative offices.

Planned improvements include:

- installation of a new infant playground
- renovation of existing playground for three and four year olds
- architectural fencing for the perimeter of the entire block
- security gates with combination key pad entry system
- installation of a Manna food garden and butterfly garden
- construction of 42 inch garden walls and fencing to border the breezeways
- installation of a new driveway, drop-off and parking places
- creation of an attractive entryway and awning
- renovation of existing restrooms
- other interior and exterior cosmetic updates and painting

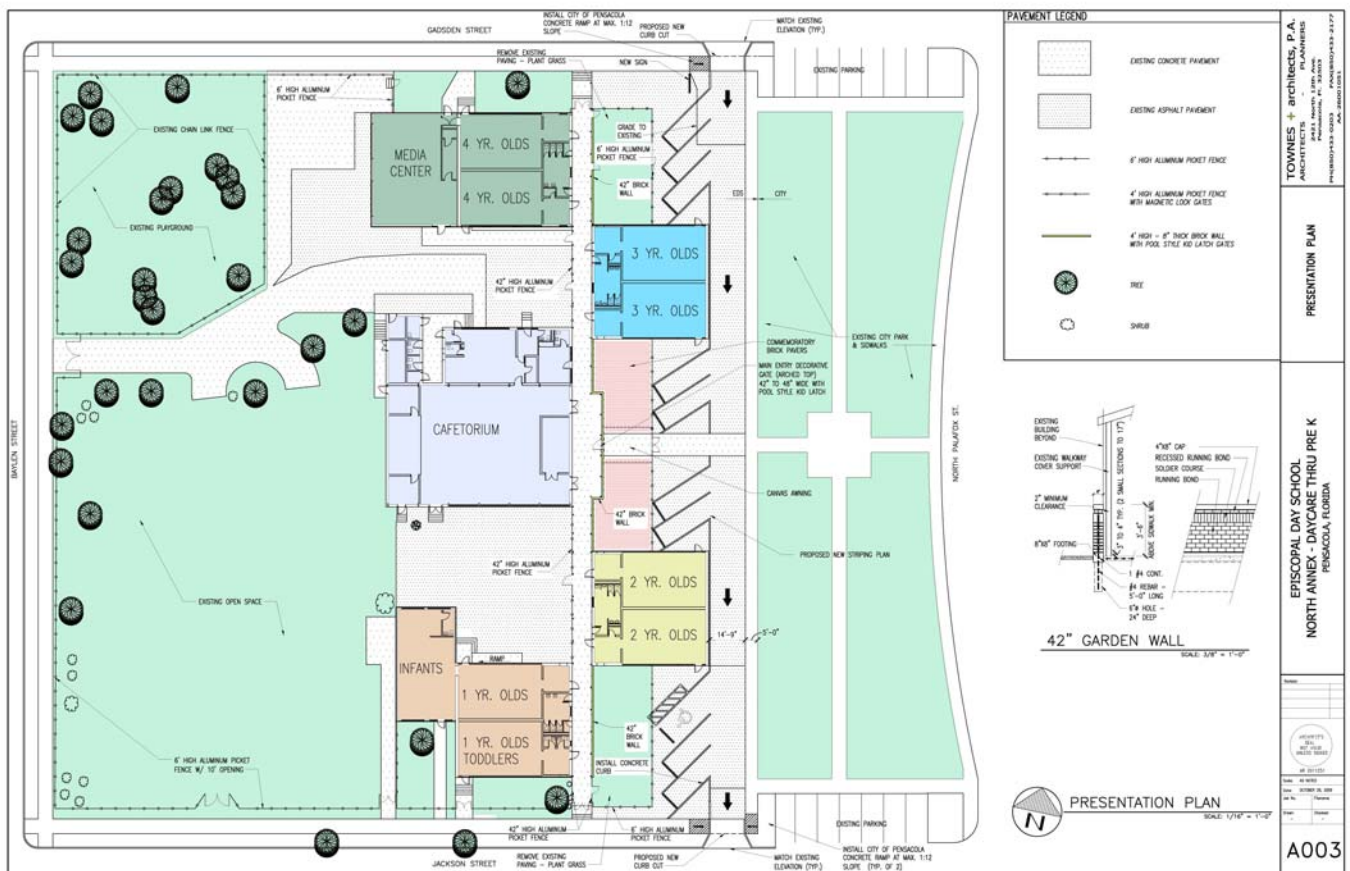

Curriculum

Beginning in the 2010-11 school year, we will implement the InvestiGator Club™ Pre-School Learning System which is a comprehensive, fully-integrated curriculum that builds upon children's natural curiosity about the world and their place in it. "Purposeful Inquiry," the heart of The InvestiGator Club, awakens the scientist and the explorer in every child. Children learn to use their senses, ask questions, and find answers in a supportive, print-rich environment.

The InvestiGator Club is a culturally rich, fully integrated curriculum that will be adapted for use at all levels of our program. The curriculum focuses on ten critical domains of learning, including literacy, math, science, social studies, oral language, and creative arts. Children are taught basic readiness skills, such as the alphabet, numbers, shapes, and colors, and they are also encouraged to experiment, build structures, appreciate fine art, sing, dance, and engage in dramatic play. Students will have enrichment classes in technology, Spanish, Christian education and physical education.

The program uses engaging stories, charming characters, and children's own curiosity to motivate them to think, solve problems, communicate, and investigate their world. The curriculum focuses on social and emotional needs as well as physical abilities for young children. Other campus activities currently being considered include speech therapy, creative dance, art, tae kwon do and on-site tutoring.

Uniforms

While uniforms are worn at the main campus, they will not be required for students in the infant – two year old program. Beginning in PreK3 students are required to wear uniforms. There are many clothing options to choose from and we also offer a used-uniform sale and uniform assistance program. We currently purchase uniforms from Lands' End and another school uniform company. We will offer a uniform re-sale and new uniform store before school begins in August.

Enrollment

In order to apply for admission, please submit an application to Kim Stafford in the Episcopal Day School Admissions office.

If you have any questions regarding this information, please contact Kim Stafford in the Admissions Office at 434-6474 or via email at kstafford@edsc.org.